



io5 / io6 / io6 Pro

Quick Installation Guide



Scan for full installation guide

This is a quick installation guide for the Ratio io5 and io6 charger, developed for qualified and experienced technicians. For more detailed information, see the online installation manuals.

Mounting the charger:

1. Use the drilling template provided to ensure the holes are in the correct location
2. Drill the holes in the desired location using an appropriate drill and drill bit
3. Align the charger with the holes in the wall and secure it with four 5mm x 35mm screws (not included)

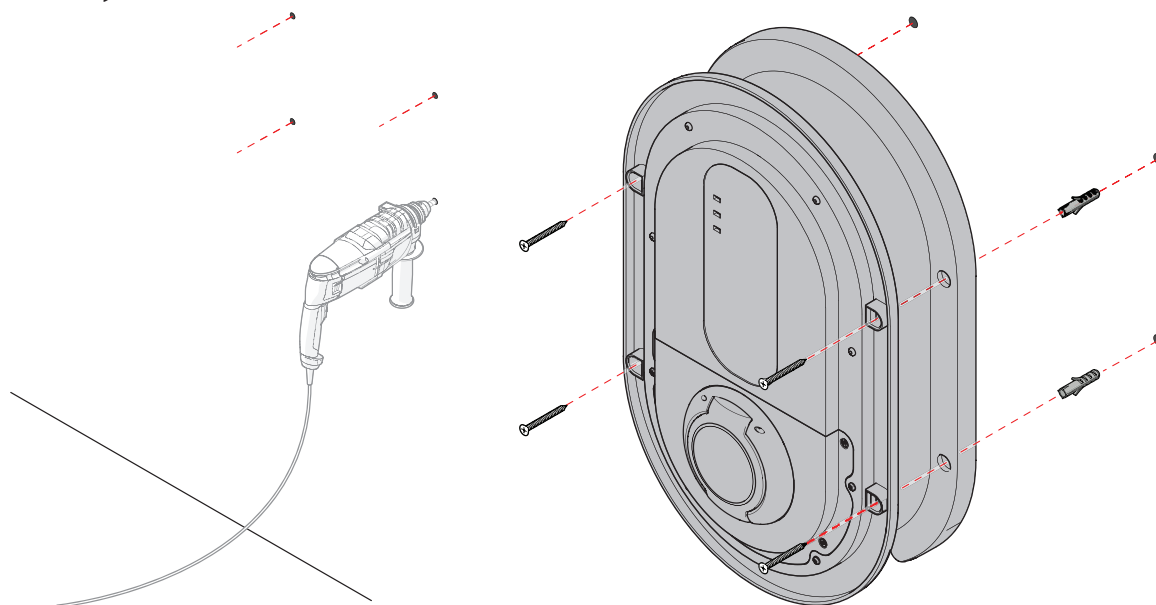

Connecting the charger:

1. Remove the access cover

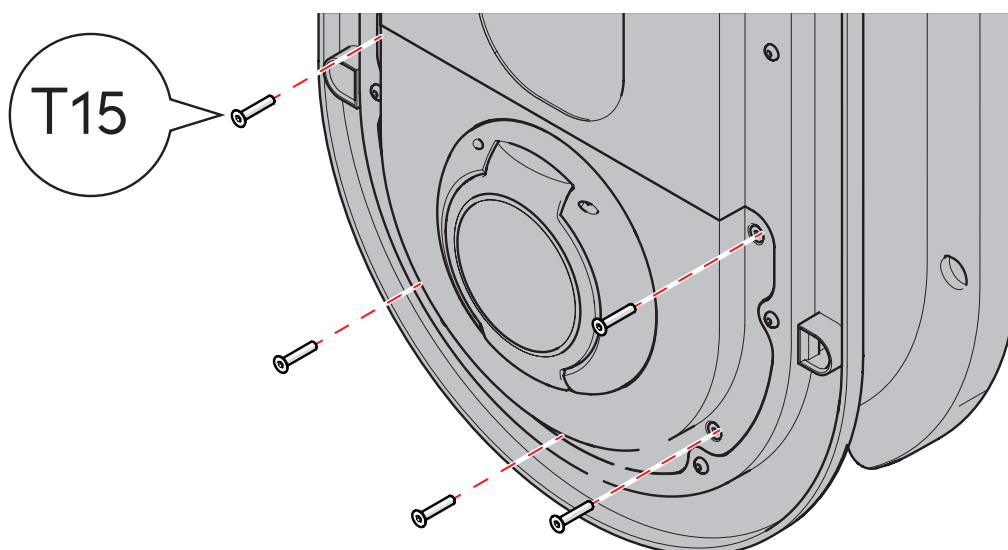

2. Install the cables into the terminal block using a 6mm cable unless otherwise stated by the Electrical Designer/Engineer.

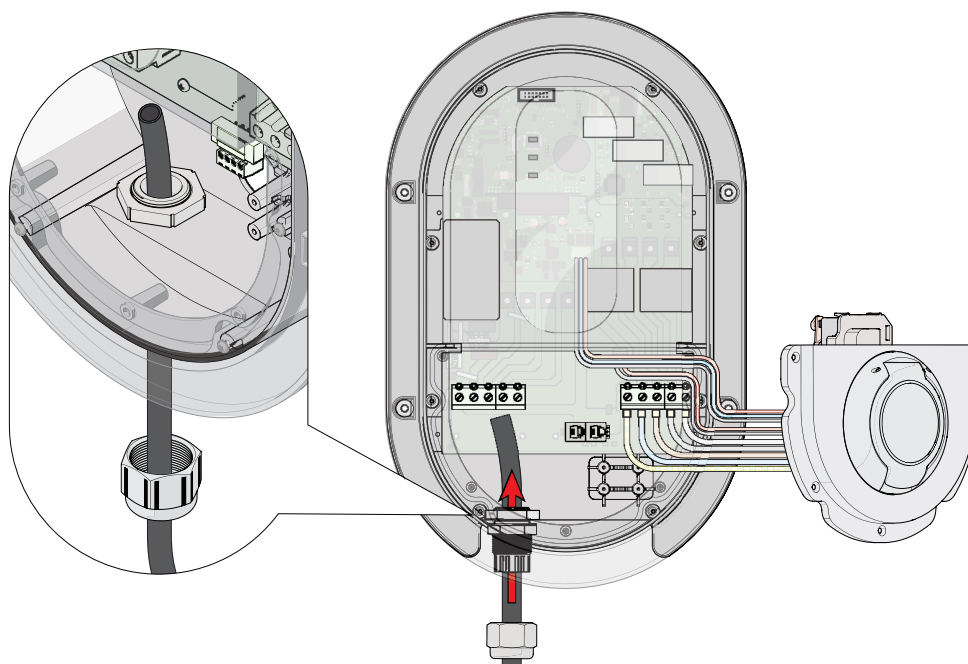

3. Terminate the cables

⚠ WARNING If using single phase please use the circuit protector conductor (CPC) provided. Never remove this item as it enables the open pen fault protection to function correctly

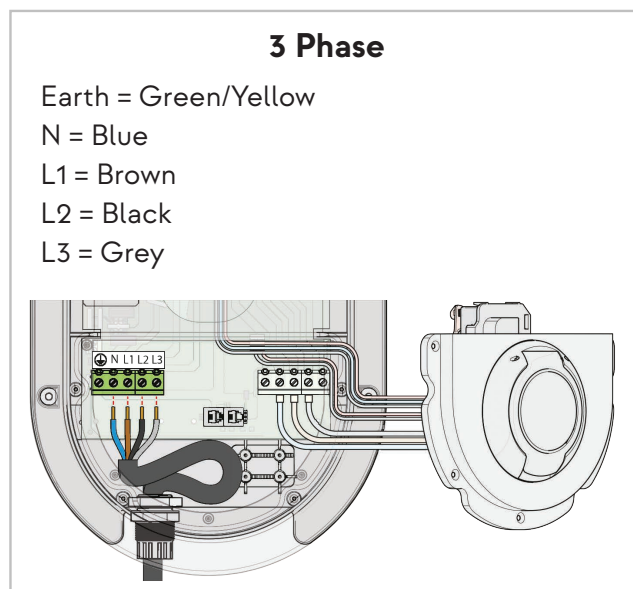
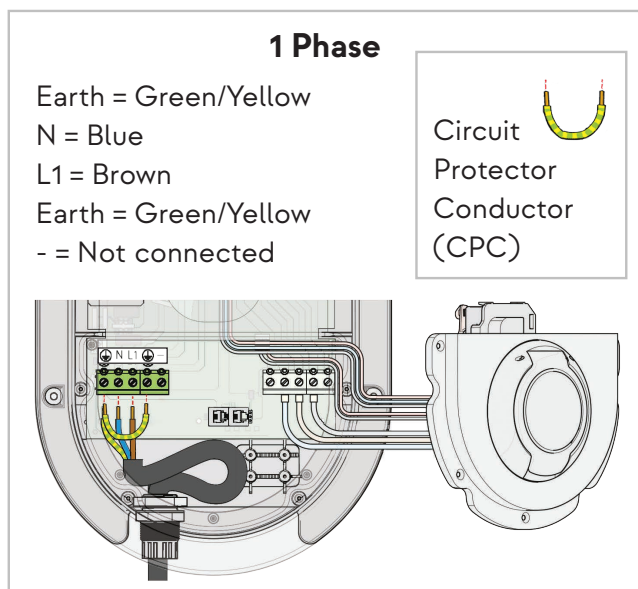

1 Phase does not apply to the io6 Pro

4. Ensure the charger is connected to type A RCBO at source

Connectivity:

1. If using hardwired Ethernet cable please ensure the black RJ45 socket is used

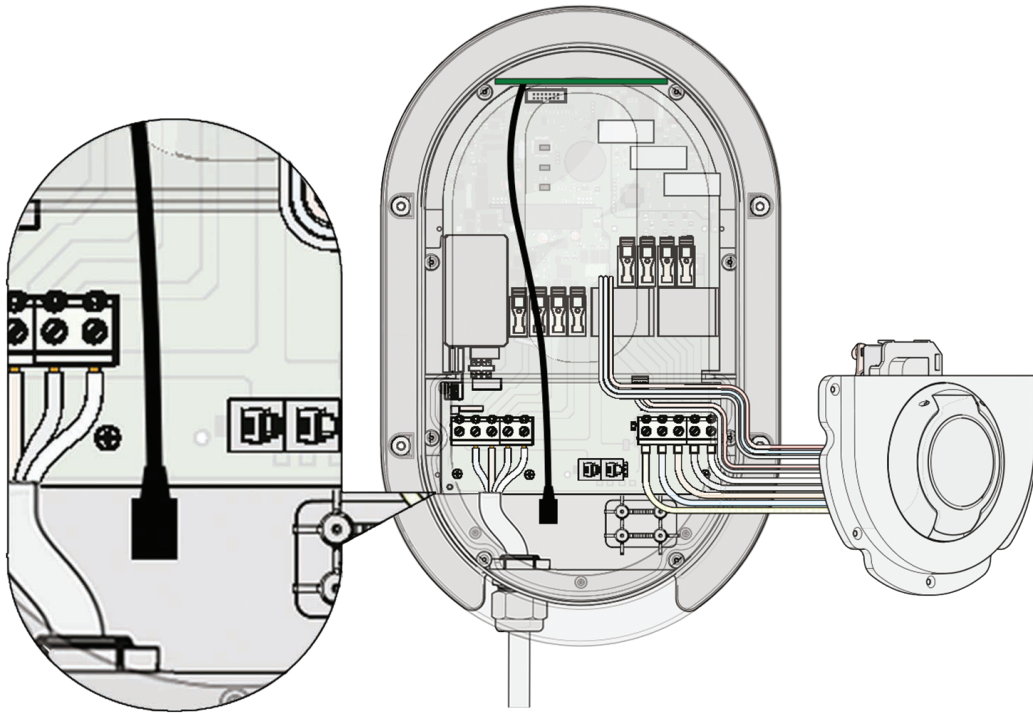

Installation of Sensor Box:

1. Prepare the cable using the supplied connectors ensuring both ends of cables are the same
2. Insert the green new style pluggable terminal block provided in the accessory pack into the location below

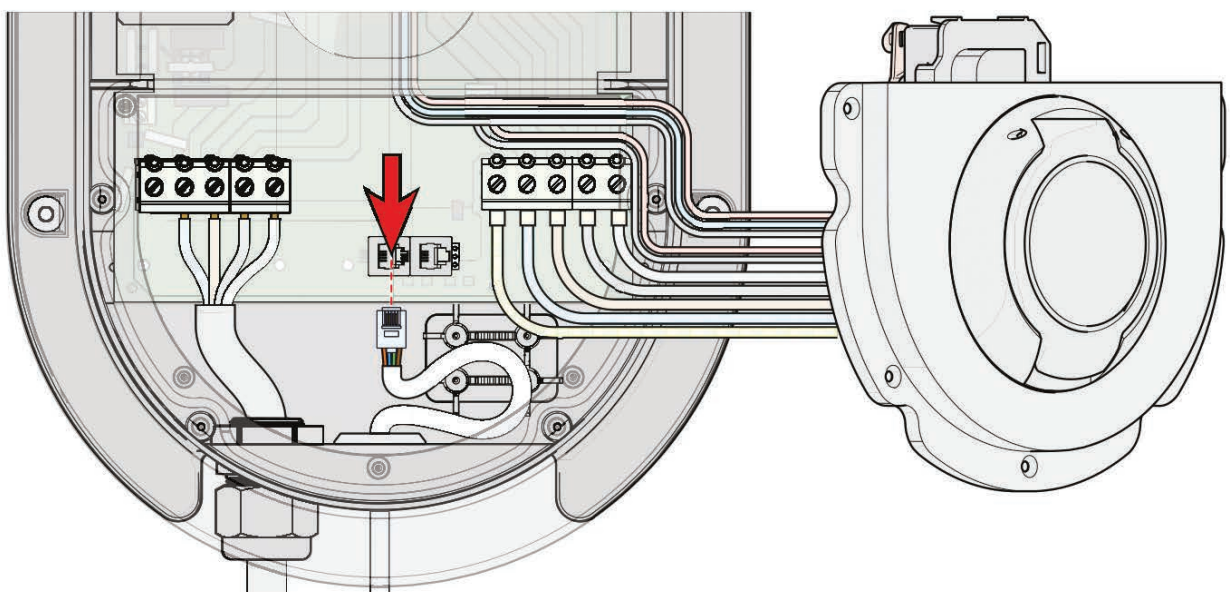

Commissioning of charger:

1. Power the charger
2. Download the Ratio app



3. Create an account in the Ratio app

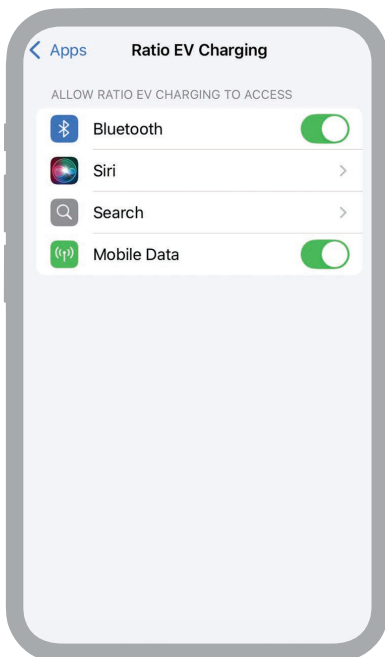

4. Ensure you turn your Bluetooth on plus allow access to Bluetooth for the Ratio EV Charging app

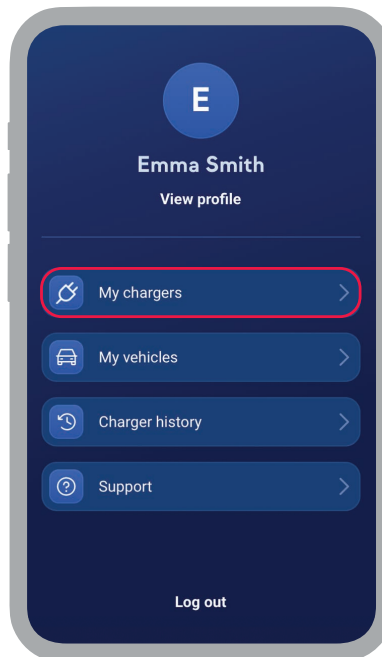

5. Select **My chargers**

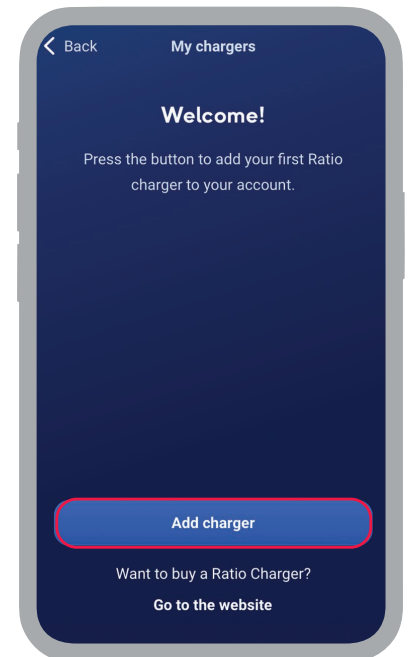

6. Add charger

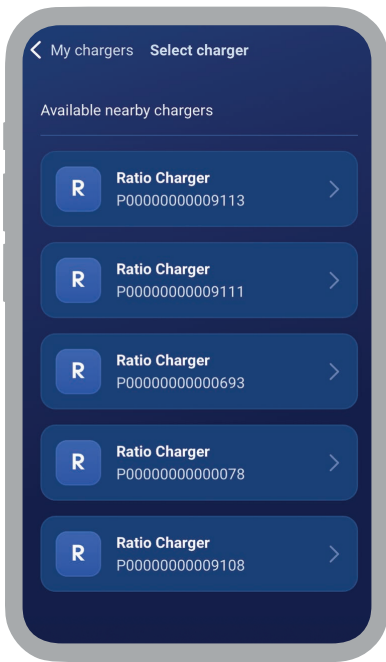

7. Select charger

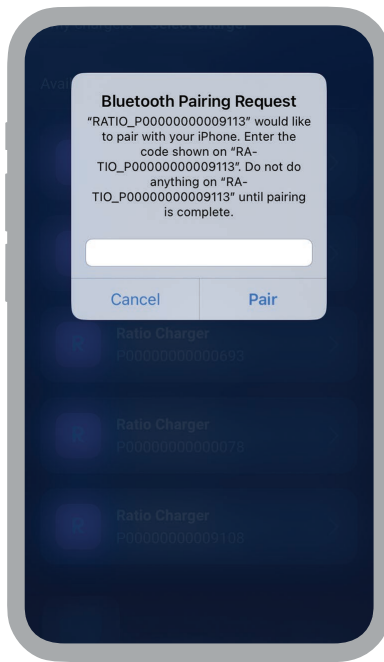

8. Add the unique Bluetooth passcode which can be found in the provided accessory pack. Please save this number for future reference

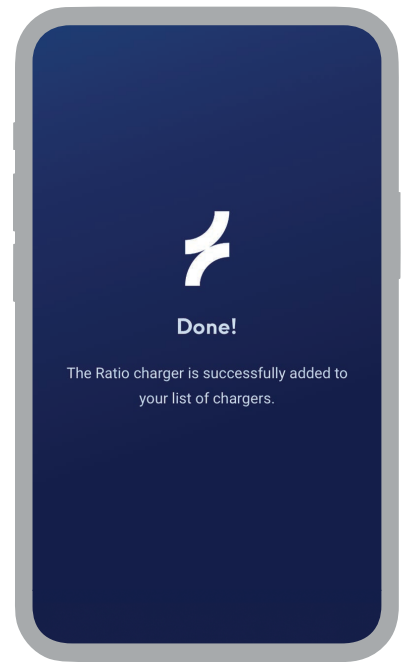

9. Your charger has now been linked to your app

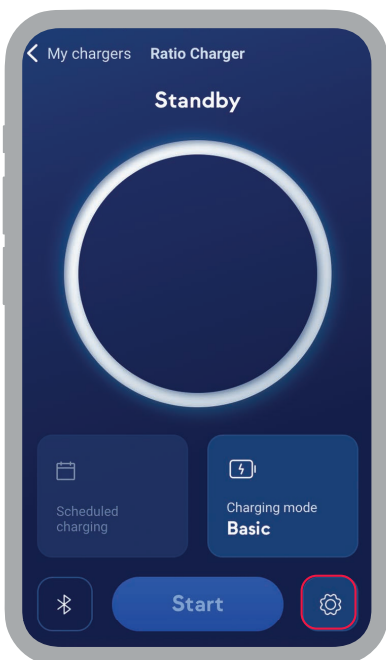

10. Click on the settings cog

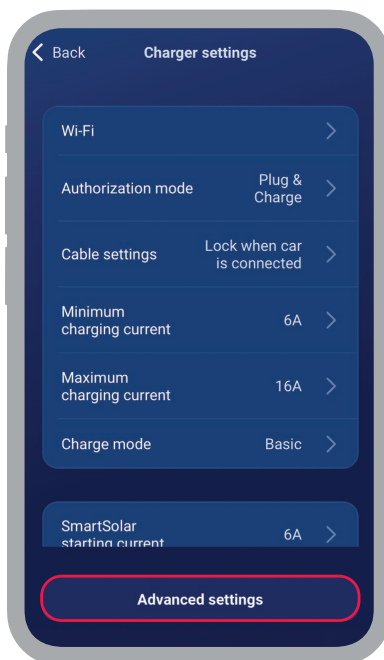

11. Click on Advanced settings

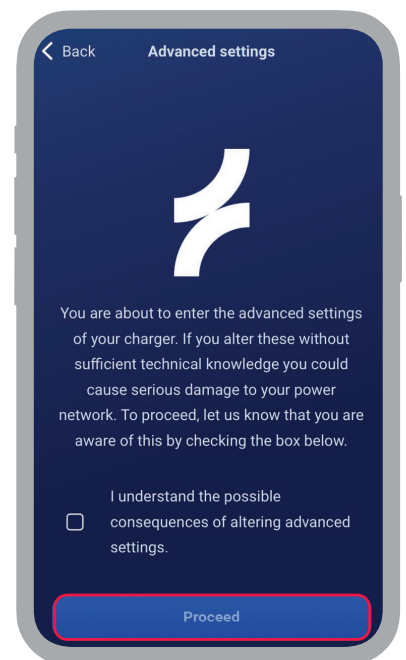

12. Click on Proceed



13. Update both **Home connection** and **Charger connection** settings (please note Home Connection is the building supply)

14. If using a back-end software provider enter **OCCP settings** and toggle on/off the CSMS to add the relevant websocket address and then **Save**

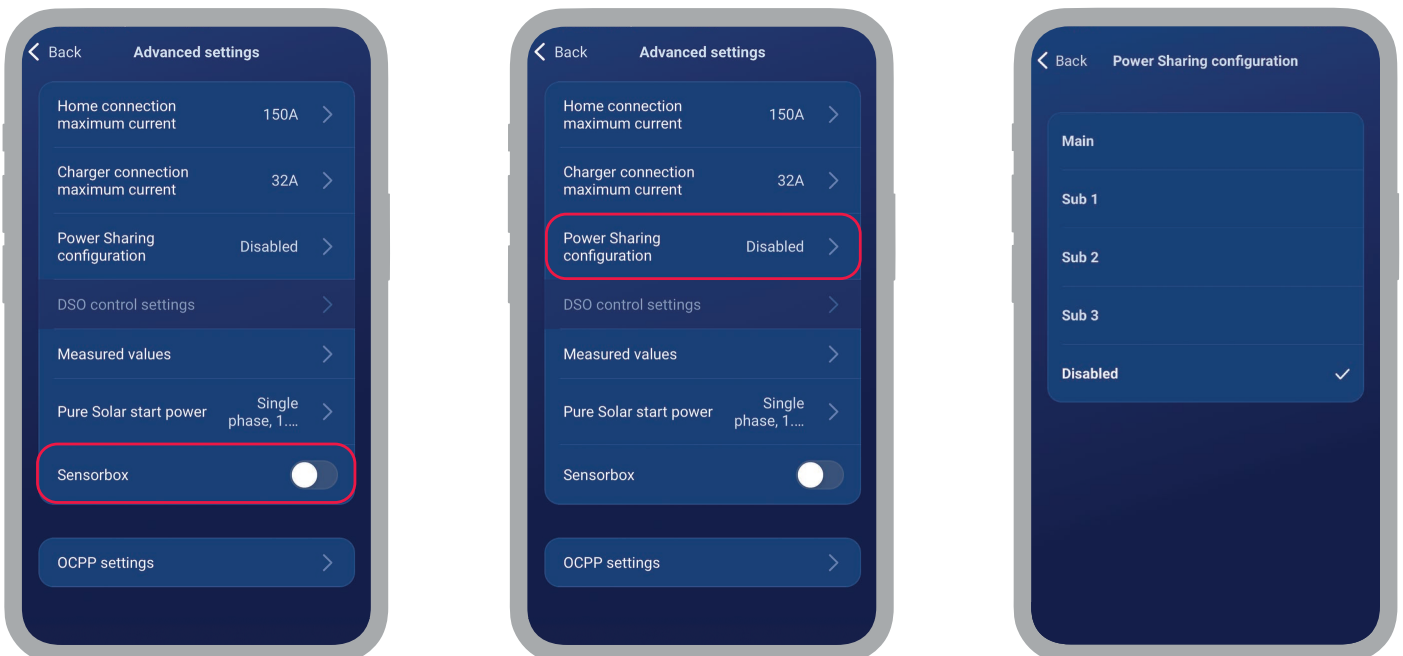

15. If this is the primary unit and dynamic load management is required toggle **Sensorbox** on, for static load management leave switched off

16. Click Power Sharing when using load management. Then select which is the main or sub units

17. Select which are main and sub units

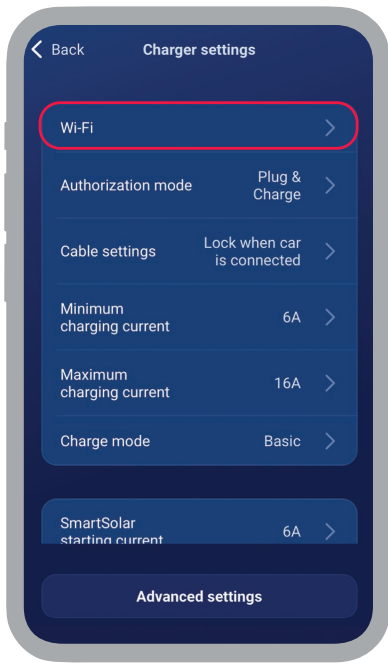

18. Return back to Advanced settings page and connect available Wi-Fi network if not using a wired ethernet cable.

19. Ensure maximum charging current is 32A

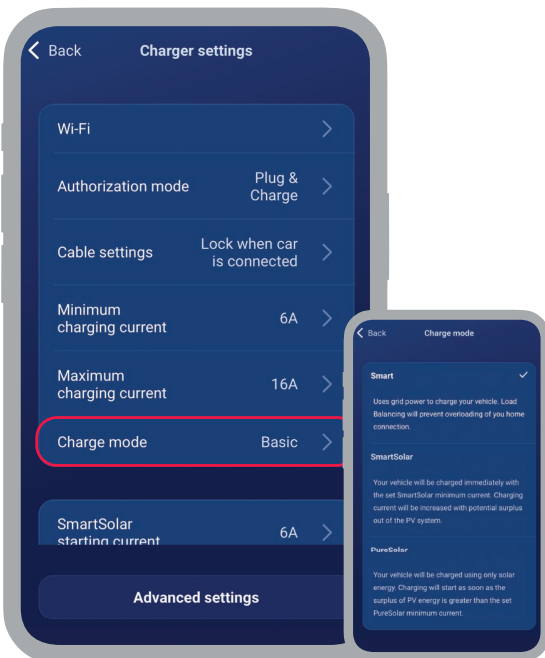

Basic: Stand alone charger setting

Smart: A set-up using dynamic load management using the Sensor box

Smart Solar: A set up using available solar power topped up with power from the grid

Pure Solar: A set up using solar power only



20. For domestic installations with solar select **Charge mode** to change

21. Scheduling of charging can be set from the main screen